

MT221-160 TOTO AQUIA DUAL BUTTON INSTALLATION INSTRUCTIONS

FITS TOTO CST412MF, CST412MF.10, CST414M, CST416M, CST464MF

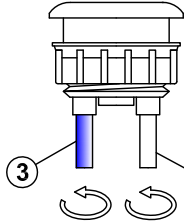
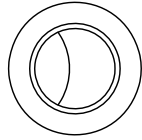

IF ADJUSTMENT RODS ARE NOT INSTALLED

- ① UNSCREW WHITE ROD. A PLIERS CAN BE USED IF ROD IS TIGHT.
- ② REPLACE WITH ADJUSTABLE ROD WITH GROOVES, SCREW AND NUT. TIGHTEN LIGHTLY WITH PLIERS.
- ③ UNSCREW BLUE ROD AND REPLACE WITH ADJUSTABLE ROD WITHOUT GROOVES. TIGHTEN LIGHTLY WITH PLIERS.

IF ADJUSTMENT RODS ARE INSTALLED

- ④ **CAUTION** IF INSTALLING IN CST414 THE NUTS MAY HAVE TO BE REMOVED TO LOWER THE SCREW.
CAUTION IF INSTALLING IN CST464MF THE SCREWS MAY BE SHORT. REPLACE WITH **1 3/8" SCREWS** SUPPLIED.
- ⑤ UNSCREW ROUND NUT, INSTALL BUTTON AND TIGHTEN BY HAND. MAKE SURE BUTTONS ARE ALIGNED PROPERLY.
- ⑥ ADJUST HIGH FLUSH (WITH GROOVES) FIRST. IF THE SCREW IS TOO LOW TURN CCW, IF THE SCREW IS TOO HIGH TURN CW. ONE TURN IS 1/32". DO NOT SECURE WITH NUT.
- ⑦ REPLACE LID AND TEST AT LEAST TWO TIMES.
- ⑧ ADJUST LOW FLUSH BUTTON IN THE SAME WAY.
- ⑨ SECURE SCREWS BY TIGHTENING THE NUT CW. REPLACE LID, FLUSH SEVERAL TIMES TO MAKE SURE THERE IS NO LEAKAGE.

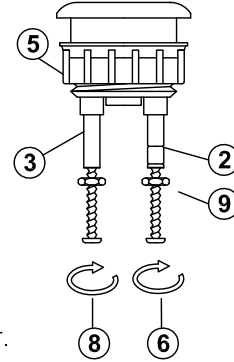
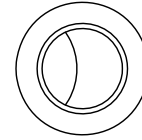

MT221-160 TOTO AQUIA DUAL BUTTON INSTALLATION INSTRUCTIONS

FITS TOTO CST412MF, CST412MF.10, CST414M, CST416M, CST464MF

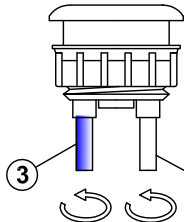
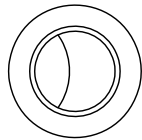

IF ADJUSTMENT RODS ARE NOT INSTALLED

- ① UNSCREW WHITE ROD. A PLIERS CAN BE USED IF ROD IS TIGHT.
- ② REPLACE WITH ADJUSTABLE ROD WITH GROOVES, SCREW AND NUT. TIGHTEN LIGHTLY WITH PLIERS.
- ③ UNSCREW BLUE ROD AND REPLACE WITH ADJUSTABLE ROD WITHOUT GROOVES. TIGHTEN LIGHTLY WITH PLIERS.

IF ADJUSTMENT RODS ARE INSTALLED

- ④ **CAUTION** IF INSTALLING IN CST414 THE NUTS MAY HAVE TO BE REMOVED TO LOWER THE SCREW.
CAUTION IF INSTALLING IN CST464MF THE SCREWS MAY BE SHORT. REPLACE WITH **1 3/8" SCREWS** SUPPLIED.
- ⑤ UNSCREW ROUND NUT, INSTALL BUTTON AND TIGHTEN BY HAND. MAKE SURE BUTTONS ARE ALIGNED PROPERLY.
- ⑥ ADJUST HIGH FLUSH (WITH GROOVES) FIRST. IF THE SCREW IS TOO LOW TURN CCW, IF THE SCREW IS TOO HIGH TURN CW. ONE TURN IS 1/32". DO NOT SECURE WITH NUT.
- ⑦ REPLACE LID AND TEST AT LEAST TWO TIMES.
- ⑧ ADJUST LOW FLUSH BUTTON IN THE SAME WAY.
- ⑨ SECURE SCREWS BY TIGHTENING THE NUT CW. REPLACE LID, FLUSH SEVERAL TIMES TO MAKE SURE THERE IS NO LEAKAGE.

